

Collins Park Shopping Center | New Castle, Delaware

FOR LEASE



Shopping Center Anchored by Family Dollar
Located just minutes from I-295 & New Jersey

TSIONAS
Tsionasinc.com

GEORGE SCHMITT
Tsionas Management Co., Inc.
2000 Pennsylvania Avenue, Suite 108, Wilmington, DE 19806
gschmitt@tsionasinc.com | 610.416.5099 | 302.888.1000

Collins Park Shopping Center | New Castle, Delaware

FOR LEASE



LOCATION

200 New Castle Avenue
New Castle, DE 19720
New Castle County

GLA

20,000 SF

TRAFFIC COUNT

14,934 VPD - New
Castle Ave.

PROPERTY HIGHLIGHTS

- Located on Route 9 / New Castle Avenue
- Convenience strip center serving the local community
- Minutes from I-295 and New Jersey
- Anchored by Family Dollar
- Highly sought after location with high occupancy

Join...

FAMILY DOLLAR

metro
by T-Mobile

**Terrance
Athletic Club**

**Express
Wings**

**Deep
Tobacco Outlet**

**China
Inn**

**Tienda
Mexicana**

ATEXQUITA



TSIONAS
Tsiomasinc.com

Tsiomas Management Co., Inc.
2000 Pennsylvania Avenue, Suite 108
Wilmington, DE 19806

Collins Park Shopping Center | New Castle, Delaware

FOR LEASE



Collins Park Shopping Center | New Castle, Delaware

FOR LEASE

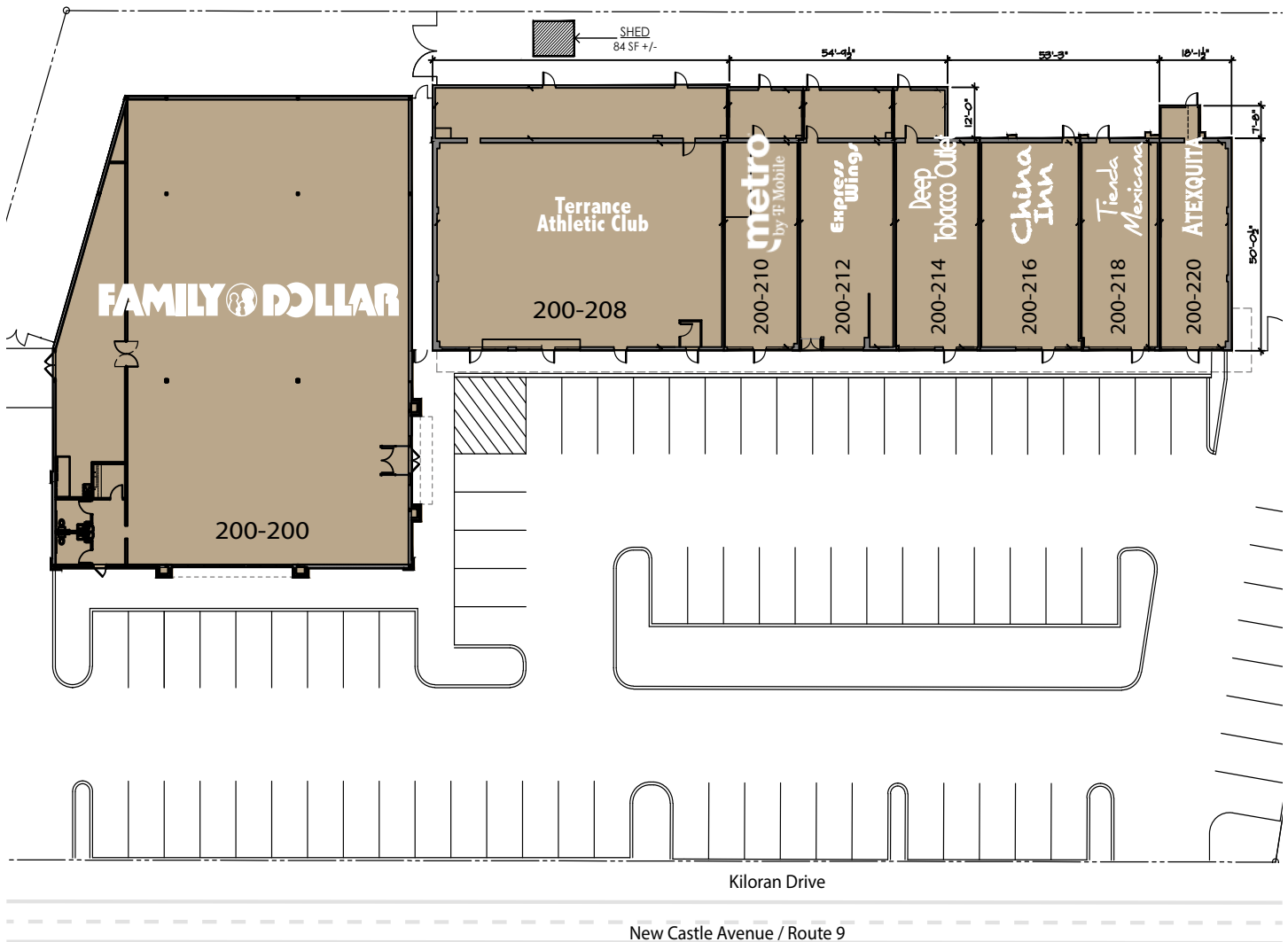

- 200-200 Family Dollar Store, Inc
- 200-208 Terrance Athletic Club
- 200-210 METRO By T Mobile
- 200-212 Express Wings
- 200-214 Deep Tobacco Outlet
- 200-216 China Inn
- 200-218 Tienda Mexicana
- 200-220 Atexquita

Collins Park Shopping Center | New Castle, Delaware

FOR LEASE

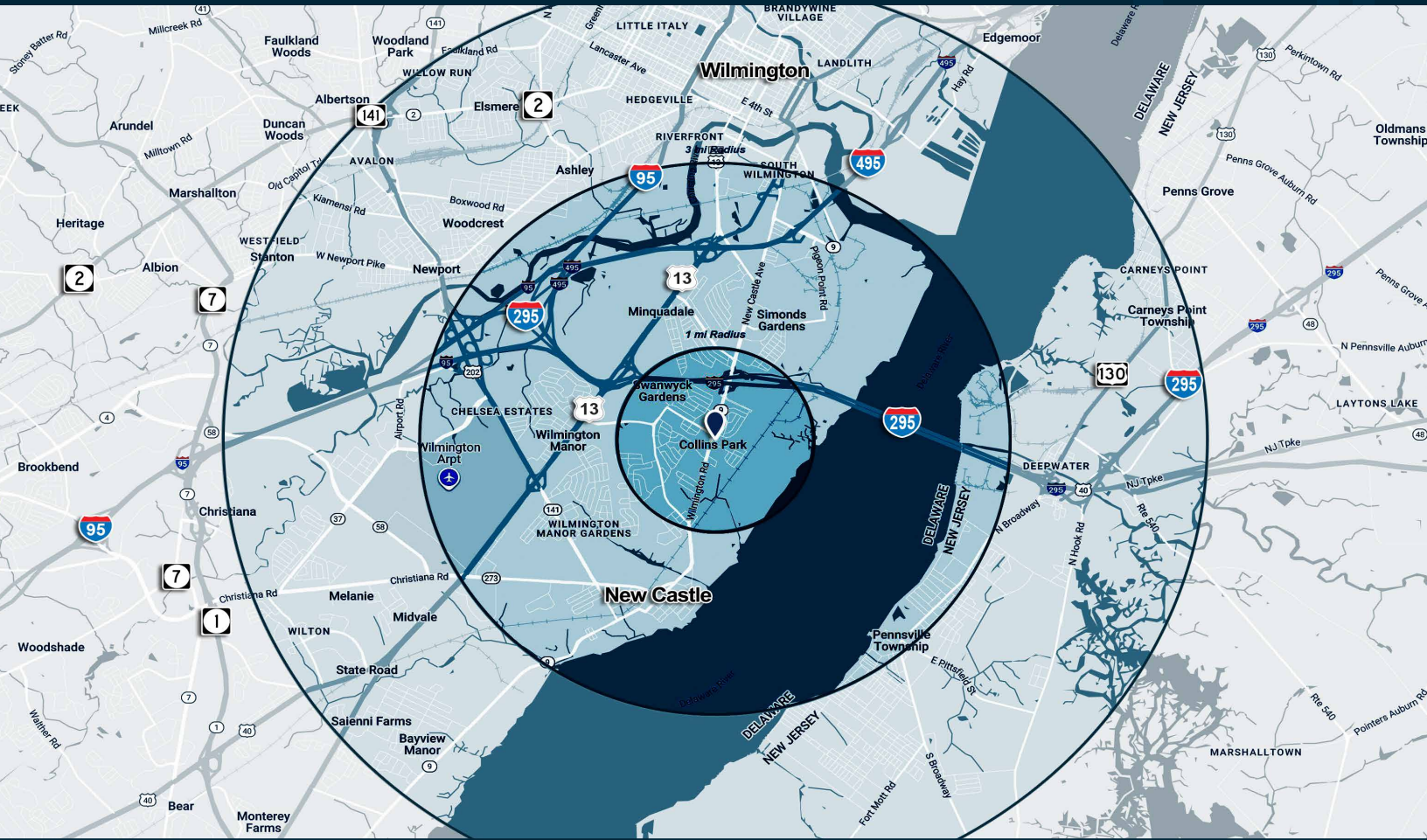

TSIONAS
Tsiomasinc.com

Tsiomas Management Co., Inc.
2000 Pennsylvania Avenue, Suite 108
Wilmington, DE 19806

Collins Park Shopping Center | New Castle, Delaware

FOR LEASE

| Population | 1 mi | 3 mi | 5 mi |
|---|----------|----------|----------|
| 2024 Estimated Population | 9,028 | 36,496 | 163,060 |
| 2029 Projected Population | 9,226 | 37,127 | 165,994 |
| 2020 Census Population | 9,142 | 37,102 | 158,936 |
| 2010 Census Population | 8,970 | 36,112 | 156,615 |
| Projected Annual Growth 2024 to 2029 | 0.4% | 0.3% | 0.4% |
| Historical Annual Growth 2010 to 2024 | - | - | 0.3% |
| 2024 Median Age | 38.5 | 38.8 | 37.2 |
| Households | | | |
| 2024 Estimated Households | 3,370 | 14,184 | 67,312 |
| 2029 Projected Households | 3,456 | 14,491 | 69,110 |
| 2020 Census Households | 3,233 | 13,950 | 63,784 |
| 2010 Census Households | 3,107 | 13,172 | 60,811 |
| Projected Annual Growth 2024 to 2029 | 0.5% | 0.4% | 0.5% |
| Historical Annual Growth 2010 to 2024 | 0.6% | 0.5% | 0.8% |
| Race and Ethnicity | | | |
| 2024 Estimated White | 43.1% | 46.5% | 43.2% |
| 2024 Estimated Black or African American | 35.6% | 36.0% | 39.6% |
| 2024 Estimated Asian or Pacific Islander | 1.2% | 1.6% | 2.5% |
| 2024 Estimated American Indian or Native Alaskan | 0.8% | 0.6% | 0.5% |
| 2024 Estimated Other Races | 19.3% | 15.4% | 14.2% |
| 2024 Estimated Hispanic | 23.0% | 17.9% | 16.2% |
| Income | | | |
| 2024 Estimated Average Household Income | \$92,951 | \$95,853 | \$89,925 |
| 2024 Estimated Median Household Income | \$70,911 | \$73,388 | \$67,527 |
| 2024 Estimated Per Capita Income | \$34,706 | \$37,315 | \$37,199 |
| Education (Age 25+) | | | |
| 2024 Estimated Elementary (Grade Level 0 to 8) | 3.7% | 4.9% | 4.1% |
| 2024 Estimated Some High School (Grade Level 9 to 11) | 9.7% | 7.2% | 7.0% |
| 2024 Estimated High School Graduate | 42.6% | 38.7% | 37.7% |
| 2024 Estimated Some College | 17.6% | 18.8% | 18.1% |
| 2024 Estimated Associates Degree Only | 7.0% | 7.3% | 7.2% |
| 2024 Estimated Bachelors Degree Only | 11.5% | 12.3% | 15.2% |
| 2024 Estimated Graduate Degree | 7.9% | 10.8% | 10.5% |
| Business | | | |
| 2024 Estimated Total Businesses | 284 | 2,173 | 9,467 |
| 2024 Estimated Total Employees | 5,938 | 31,361 | 131,788 |
| 2024 Estimated Employee Population per Business | 20.9 | 14.4 | 13.9 |
| 2024 Estimated Residential Population per Business | 31.7 | 16.8 | 17.2 |